

# GARMIN® FORCE® TROLLING MOTOR LATCH RETENTION KIT INSTALLATION INSTRUCTIONS

## Getting Started

### ⚠ WARNING

Always disconnect the trolling motor from the battery before performing any service.

Do not run the motor when the propeller is out of the water. Contact with the rotating propeller may result in severe injury.

### ⚠ CAUTION

When stowing or deploying the motor, be aware of the risk of entrapment or pinching from moving parts, which can result in injury.

You should read these instructions completely before beginning this service, and make sure that you have the tools and skill set needed to complete it. If necessary, you should use a qualified marine installer to ensure proper service.

To aid with the installation, you can view a video of this process at [www.garmin.com/videos/trolling\\_motor\\_latch\\_kit](http://www.garmin.com/videos/trolling_motor_latch_kit).

### Tools Needed

- #1 Phillips screwdriver
- #2 Phillips screwdriver
- Needle-nose pliers
- 4 mm hex bit or wrench
- Approximately 60 cm (2 ft.) length of rigid plastic tubing, pipe, or PVC with an inner diameter of approximately 25 mm (1 in.)
- The cardboard box containing the parts for this kit

## Replacing the Locking Mechanism

The first part of installing this latch kit is to replace the latch bar and spring in the locking mechanism with the new parts provided in this kit.

### ⚠ CAUTION

Use extreme care when working on the trolling motor when supporting it in the partially-stowed position. A falling motor may crush or pinch hands and fingers.

- 1 Transition the trolling motor to a partially-stowed position and place a piece of rigid plastic tubing, pipe, or PVC ① over the stabilizer rod to add additional support and prevent the latching mechanism from engaging and locking the motor in the stowed position.

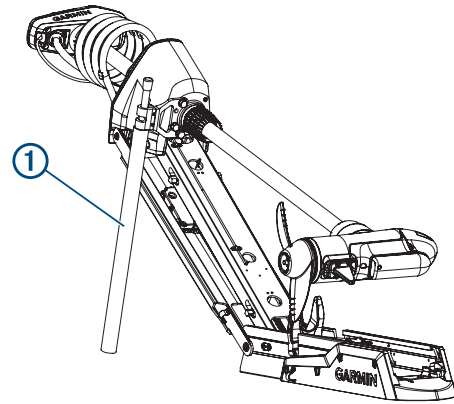

**NOTE:** If you did not install the stabilizer on your trolling motor, you should support the motor on a sturdy object to prevent it from locking in the stowed position.

- 2 Disconnect the lower gas spring (*Disconnecting the Lower Gas Spring, page 1*).
- 3 Remove the existing spring and lower latch bar (*Removing the Existing Latch Bar, page 1*).
- 4 Install the new latch bar and spring (*Installing the New Latch Bar, page 2*).
- 5 Reconnect the lower gas spring (*Reconnecting the Lower Gas Spring, page 2*).

### Disconnecting the Lower Gas Spring

- 1 Using a #2 Phillips screwdriver, remove the screws ① that secure the lower gas spring clevis ② to the lower link of the mount.

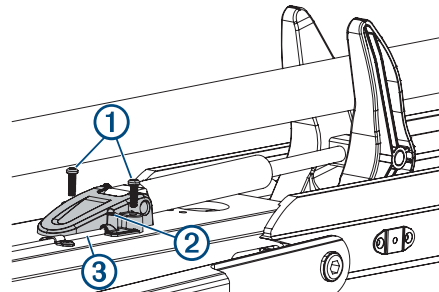

- 2 Lift the lower gas spring clevis off of the safety rod ③.

### Removing the Existing Latch Bar

- 1 Using a pair of needle-nose pliers, disconnect the latch spring ① from the s-hook ② on the mount base.

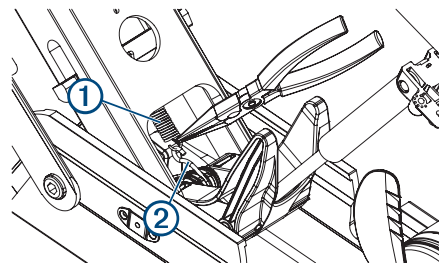

- 2 Using the access hole in the lower link ③, remove the spring from the end of the rod in the latching mechanism ④.

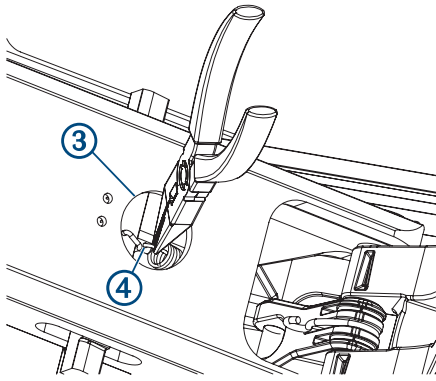

- 3 Using needle-nose pliers, remove the pin ⑤ that secures the latch bar to the rod.

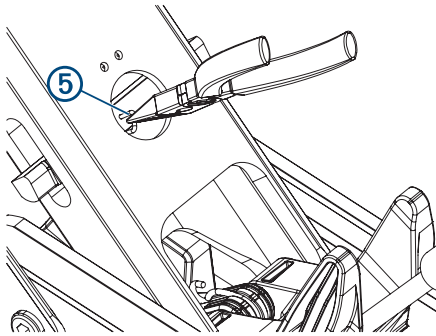

- 4 Push the rod up until it is free from the latch bar, and slide the latch bar out of the lower link.

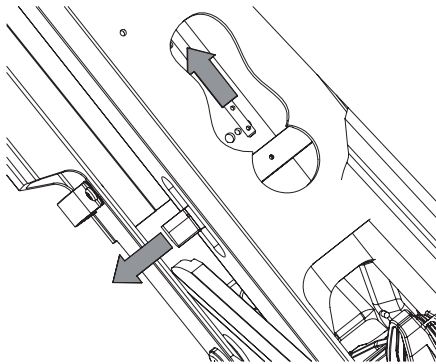

**NOTE:** You can set aside or dispose of the old spring, pin, and latch bar. You will replace those parts with the parts supplied in this kit.

### Installing the New Latch Bar

- 1 With the curved portion of the latch ① facing away from you and the wire hook ② pointing downward, slide the new latch bar into the lower link.

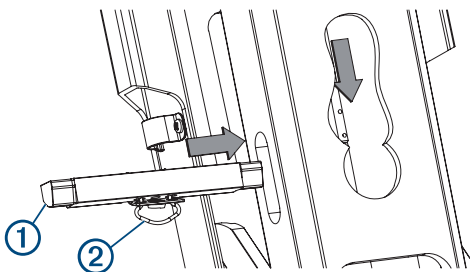

- 2 Feed the rod from the locking mechanism through the hole in the top of the new latch bar until the pin hole ③ in the rod is visible.

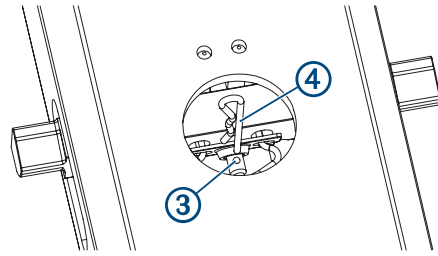

- 3 Push the R-pin included in this kit ④ through the pin hole in the rod from the locking mechanism to secure the new latch bar to the rod.

- 4 Place one end of the new spring ⑤ included in this kit over the wire hook on the new latch bar.

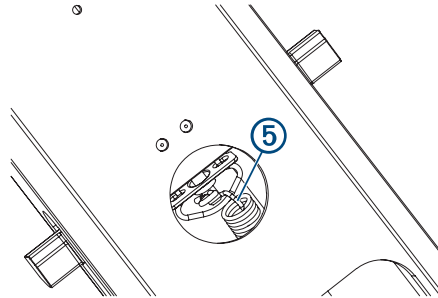

- 5 Using needle-nose pliers, secure the other end of the new spring onto the S-hook ⑥ on the mount base.

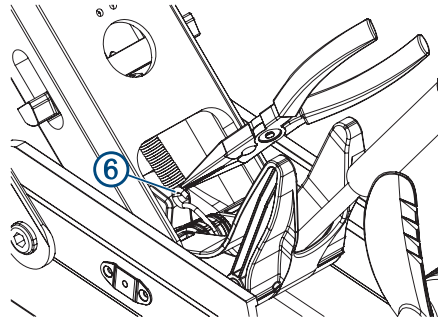

### Reconnecting the Lower Gas Spring

- 1 Place the lower gas spring clevis ① on the lower link of the mount, fitting it over the safety rod ②

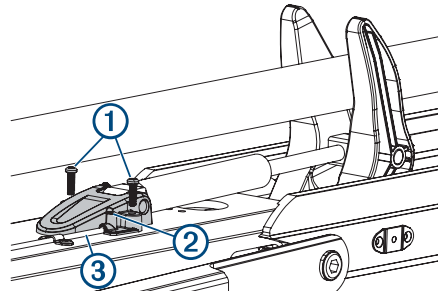

- 2 Using a #2 Phillips screwdriver, install the screws ③ that secure the lower gas spring clevis to the lower link of the mount.

**NOTE:** Extra screws are provided in this kit if needed.

## Installing the Latch Clip

### ⚠ CAUTION

Use extreme care when working on the trolling motor when supporting it in the partially-deployed position. A falling motor may crush or pinch hands and fingers.

After replacing the locking mechanism, you should install the included latch clip.

- 1 Transition the trolling motor to a partially-deployed position, and place the box from this latch kit ① in the mount base to support the trolling motor and prevent the latching mechanism from engaging and locking the motor in the deployed position.

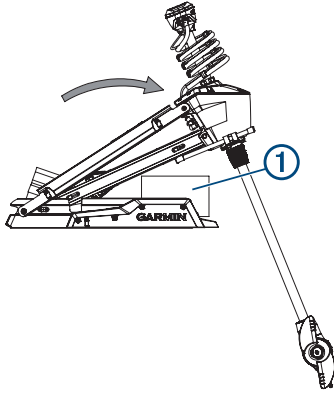

**NOTE:** If you discarded the package from this latch kit, you should support the motor using a sturdy object to prevent it from locking in the deployed position.

- 2 Disconnect the upper gas spring (*Disconnecting the Upper Gas Spring*, page 3).
- 3 Install the latch clip on the lower link (*Installing the Latch Clip on the Lower Link*, page 3).
- 4 Reconnect the upper gas spring (*Reconnecting the Upper Gas Spring*, page 3).

### Disconnecting the Upper Gas Spring

- 1 Using a #0 Phillips screwdriver, loosen the set screw ① that secures the gas spring pin ② to the upper gas spring arm ③.

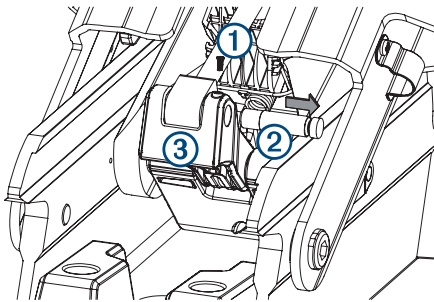

**NOTE:** You can loosen the set screw without removing it from the gas spring arm. This may help keep the screw from becoming lost.

- 2 Slide out the gas spring pin, and lift up on the gas spring to disconnect it.

### Installing the Latch Clip on the Lower Link

- 1 With the narrow portion of the included latch clip ① facing up, slide it onto the top part of the lower link ②.

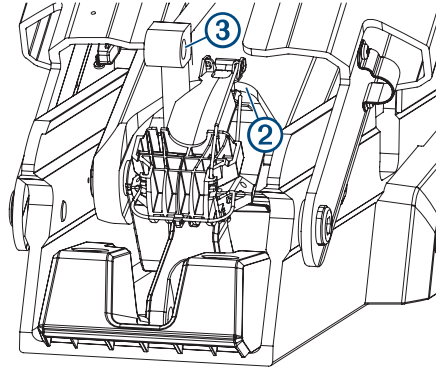
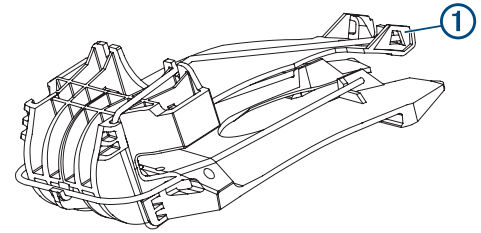

**NOTE:** You may need to lift up on the gas spring ③ when installing the latch clip on the lower link.

- 2 Press the clip onto the lower link until it snaps into place.

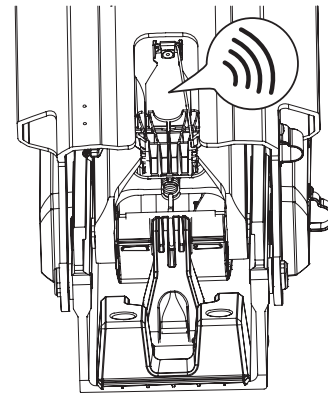

- 3 Pull on the clip to test for proper installation.

If the clip is installed properly, you cannot pull it off of the upper link.

### Reconnecting the Upper Gas Spring

- 1 Lower the gas spring and lift the gas spring arm ① until the holes align.

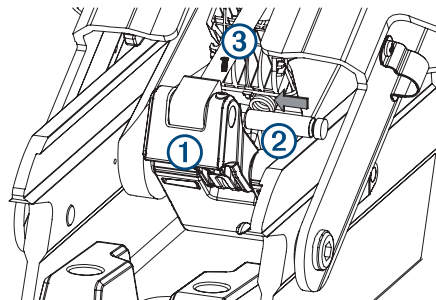

- 2 Slide the gas spring pin ② into the hole on the gas spring arm, until it is flush on both sides of the arm.

**NOTE:** The groove on the gas spring pin must align with the set screw on the gas spring arm for the set screw to properly secure the pin.

- 3 Using a #0 Phillips screwdriver, tighten the set screw ③ that secures the gas spring pin to the upper gas spring arm.

**NOTE:** An extra set screw is provided in this kit if needed.

## Replacing the Mount Base Stow Support

- 1 With the trolling motor in the deployed or partially deployed position, using a 4mm hex bit or wrench, loosen the two screws that secure the stow support to the mount base.

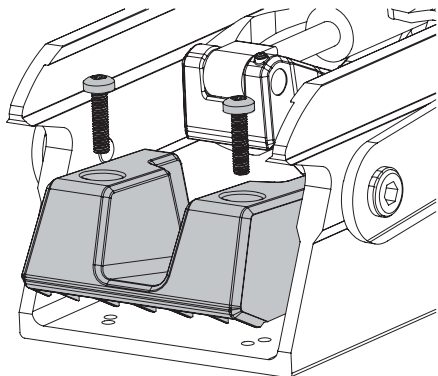

- 2 Using the screws you removed in the previous step or the replacement screws included in this kit, install the new stow support included in this kit.

© 2020 Garmin Ltd. or its subsidiaries

Garmin®, the Garmin logo, and Force® are trademarks of Garmin Ltd. or its subsidiaries, registered in the USA and other countries. These trademarks may not be used without the express permission of Garmin.