

GARMIN.

GPSMAP® 7X3\9X3\12X3 ADAPTER PLATE INSTALLATION INSTRUCTIONS

Important Safety Information

WARNING

See the *Important Safety and Product Information* guide in the GPS device product box for product warnings and other important information.

Installing the Adapter Plate

The GPSMAP 7x3/9x3/12x3 adapter plate converts an opening cut for a GPSMAP 7x2/9x2/12x2 chartplotter to be used for a GPSMAP 7x3/9x3/12x3 chartplotter. For example, if the dashboard has been cut for a GPSMAP 9x2 chartplotter, you can use the adapter kit to convert the opening to install a GPSMAP 9x3 chartplotter.

- 1 If necessary, remove the existing chartplotter from the mounting surface, and clean the surface of any existing gaskets or marine sealant.
- 2 Place the adapter plate ① over the opening, and mark the new hole locations for the new chartplotter.

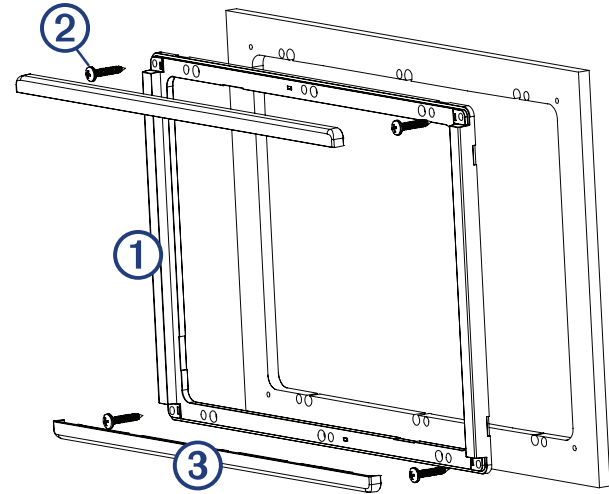

- 3 Remove the adapter plate.
- 4 Drill the holes as instructed in the *GPSMAP 7x3/9x3/12x3 Installation Instructions*.

NOTE: It might be helpful to cut slots for the nut plates instead of holes. This will allow easier installation of the nut plates.

- 5 Place the adapter plate over the opening again to verify the pilot hole locations.



- 6 Depending on the size of the existing holes, secure the adapter plate to the mounting surface using the included wood screws ② or the included machine screws and nuts.
- 7 Secure the chartplotter to the adapter plate and mounting surface using the nut plates and screws included with the chartplotter.
- 8 Follow the *GPSMAP 7x3/9x3/12x3 Installation Instructions* to complete the installation.
- 9 Snap the trim caps ③ to the top and bottom of the adapter plate.

© 2020–2022 Garmin Ltd. or its subsidiaries

Garmin®, the Garmin logo, and GPSMAP® are trademarks of Garmin Ltd. or its subsidiaries, registered in the USA and other countries. These trademarks may not be used without the express permission of Garmin.