

GARMIN®



HANDLEBAR CONTROLLER INSTALLATION INSTRUCTIONS

Important Safety Information

⚠ WARNING

See the *Important Safety and Product Information* guide in the product box for product warnings and other important information.

Installing the Controller on the Handlebar

The handlebar controller is packaged with three bushings, designed for 22 mm (7/8 in.), 25 mm (1 in.), and 32 mm (1 1/4 in.) diameter handlebars.

We recommend installing the handlebar controller close to the left handle of your vehicle, within reach of your thumb.

- 1 Place the bushing ① on the handlebar, in the mounting location for the controller.

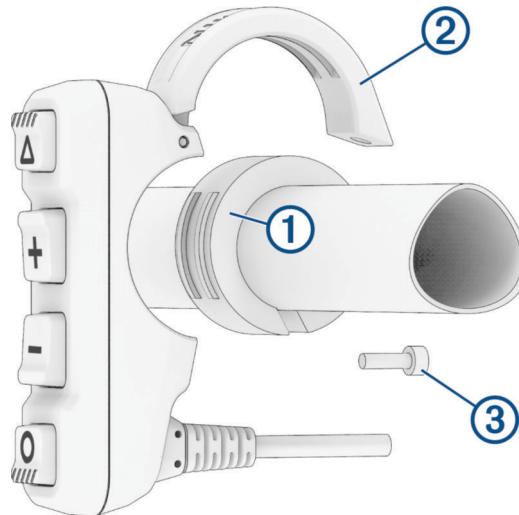

- 2 Place the handlebar controller mounting clamp ② over the bushing, making sure the ridges on the bushing match up with the grooves in the mounting clamp.
- 3 Using the included hex wrench, install the included screw ③.

Connecting the Controller

To connect the Handlebar Controller to your device, you must have a power cable with an accessory connector. If your device was not packaged with such a cable, you can purchase the Handlebar Controller Y-adapter cable for 8 in. or 10 in. Tread devices (part number 010-13087-18) or the Group Ride Radio Y-adapter cable for the zūmo XT2 navigator (part number 010-13285-00). You can purchase these accessories from your Garmin dealer or you can go to [garmin.com](https://www.garmin.com).

- 1 Route the handlebar controller cable to the accessory connector ① on the device power cable.

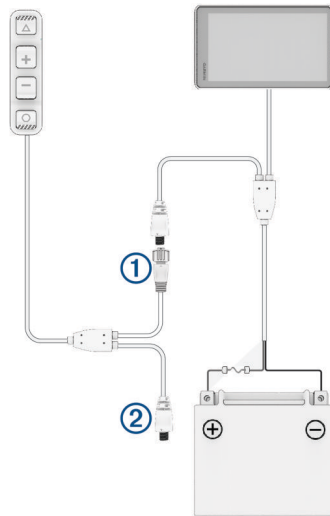

You can use the included cable ties to secure the cable along the handlebar.

- 2 Connect the handlebar controller connector to the accessory connector on the device power cable.
- 3 If you have a Group Ride Radio, connect the Group Ride Radio cable to the spare accessory connector ② built into the handlebar controller cable.
- 4 Tighten the locking rings on the connectors.

Configuring the Buttons

You can configure each button on the handlebar controller to trigger different actions.

Select  > **Handlebar Controller**.

Specifications

Water and dust resistance	IEC 60529 IP67 ¹
Operating temperature range	From -20° to 55° C (from -4° to 131° F)

© 2024 Garmin Ltd. or its subsidiaries

Garmin®, the Garmin logo, Tread® and zūmo® are trademarks of Garmin Ltd. or its subsidiaries, registered in the USA and other countries. These trademarks may not be used without the express permission of Garmin.

¹ The device is protected against the ingress of dust and withstands incidental exposure to water of up to 1 m for up to 30 min.